

**Surface-mounting pattress
pure white**

Product Data Sheet

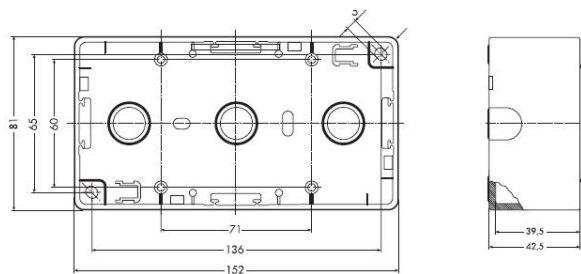

Assembly arrangement	Surface mounted housing
Mounting direction	Horizontal and vertical
Material	Plastic
Material quality	Thermoplastic
Surface protection	Untreated
Surface finishing	Glossy
Colour	White
Halogen free	Yes



Surface-mounting pattress
pure white

Surface-mounting pattress with closed pattress for vertical and horizontal mounting,
including cable entry blanking plate (article no. 29.xx) and 1 cable entry
(article no. 26.xx), 2 gang, dimensions W 81 x L 152 x H 42 mm

Not for use with DIALOG exclusiv combination frames!

Material No.	Article No.	EAN-code
00815811	D 95.692.02	4010105815818

PEHA Elektro GmbH & Co.KG

a Honeywell Company
Daimlerstraße 4
58553 HALVER
DEUTSCHLAND

Tel.: 02353 9118 001
Fax: 02353 9118 311
mail: peha@honeywell.com
www.peha.de

Änderungen vorbehalten. © Honeywell PEHA