



DIN power female connector - angled



General information

Design	IEC 60603-2	type: E
No. of contacts	max. 48	
Contact spacing	5,08mm	
Test voltage	1000V	
Contact resistance	max. 20mOhm	
Insulation resistance	min. 10 ¹⁰ Ohm	
Working current	1A at 70°C (see derating diagram)	
Temperature range	-55°C ... +125°C	
Termination technology	solder pins	
Clearance & creepage	min. 3mm	
Insertion and withdrawal force	max. 75N	
Mating cycles	PL 1 acc. to IEC 60603-2	500 mating cycles
UL file	E102079	
RoHS - compliant	Yes	
Leadfree	Yes	

Insulator material

Material	PBT (thermoplastics, glass fibre reinforcement 30%)
Colour	RAL 7032 (grey)
UL classification	UL 94-V0
Material group acc. to IEC 60664-1	IIIa (175 ≤ CTI < 400)
NF classification	I3, F4

Contact material

Contact material	Copper alloy
Plating termination zone	Sn over Ni
Plating contact zone	Au over Ni

Derating diagram acc. to IEC 60512-5 (Current carrying capacity)

The current carrying capacity is limited by maximum temperature of materials for inserts and contacts including terminals.

The current capacity curve is valid for continuous, non interrupted current loaded contacts of connectors when simultaneous power on all contacts is given, without exceeding the maximum temperature.
Control and test procedures according to DIN IEC 60512-5

With selective loading higher currents can be transmitted. The requirements according to VITA 1.7 are fulfilled.

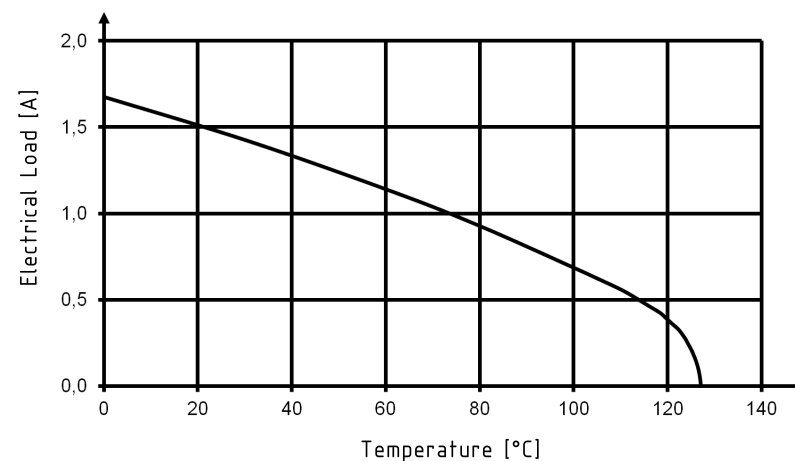

Soldering instructions

The connectors should be protected when being soldered in a dip, flow or film soldering bath. Otherwise, they might become contaminated as a result of soldering operations or deformed as a result of overheating.

(1) For prototypes and short runs protect the connectors with an industrial adhesive tape, e.g. Tesaband 4331 (www.tesa.de). Cover the underside of the connector moulding and the adjacent parts of the pcb as well as the open sides of the connector. This will prevent heat and gases of the soldering apparatus from damaging the connector. About 140 + 5 mm of the tape should suffice.

(2) For large series a jig is recommended. Its protective cover with a fast action mechanical locking device shields the connectors from gas and heat generated by the soldering apparatus. As an additional protection a foil can be used for covering the parts that should not be soldered.

Cross section of solder pins

Recommended plated hole diameter: $\varnothing 1 \pm 0,1\text{mm}$

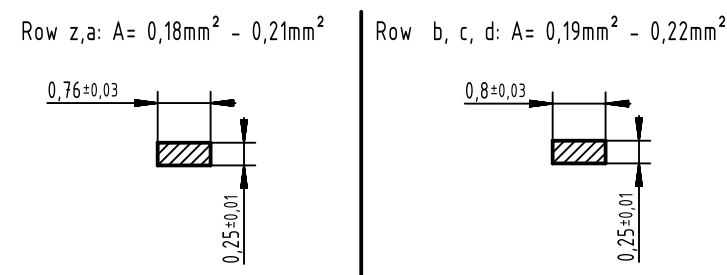

Mating conditions

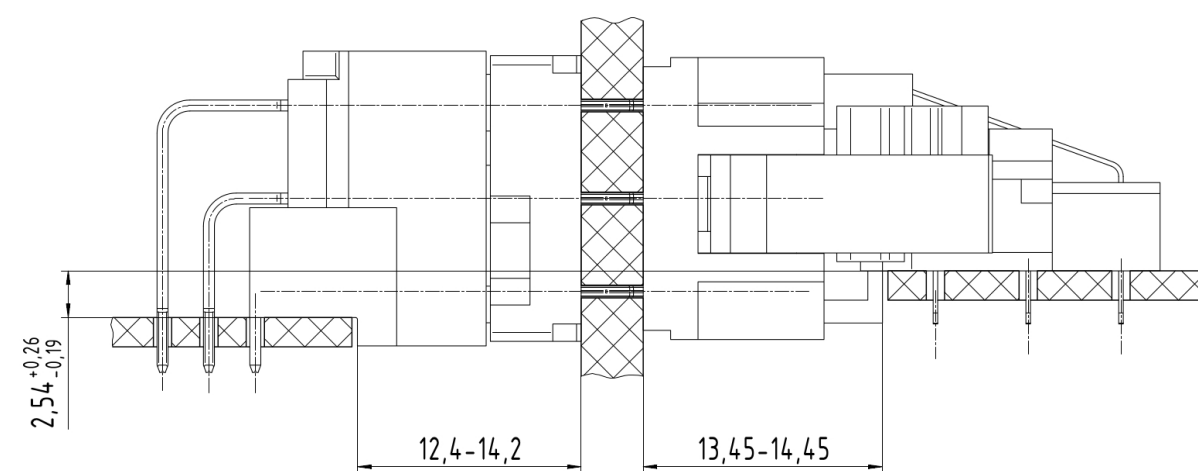

	All rights reserved	Created by	Inspected by	Standardisation	Date	State	
	Department EC PD - DE	LEHNERT	DAHMS	HOFFMANN	2017-03-08	Final Release	
HARTING Electronics GmbH D-32339 Espelkamp		Title DIN power female connector - angled				Doc-Key / ECM-Nr. 100652278/UGD/000/A 500000116633	
		Type	Number		Rev.	Page	
		DS	09052200200		A	1/1	